

Ford GT Exhaust System Installation

PN-140310



These instructions have been written to help you with the installation of your Borla Performance Exhaust System. Please read this document completely before beginning the installation of your system.

Please compare the parts in the box with the bill of materials provided to assure that you have all the parts necessary for this installation.

To ensure this part number fits your specific model year, please visit our website for the latest model year listings at www.BORLA.com.

Thank you for purchasing a Borla Performance Cat-Back™ Exhaust System.

This Borla Performance Cat-Back (140310) is designed for the Ford GT equipped with a 5.4L Supercharged V8 engine and a manual transmission.

Borla Performance Industries recommends that an exhaust shop or professional after market parts installer, who has all the necessary equipment, tools and experienced personnel needed for proper installation, should perform the installation of this system. However, if you decide to perform the installation, we recommend someone should help you. Ensure the installer uses all under car safety precautions including eye protection.

Please take time to read and understand the following...

By installing your Borla Performance Exhaust System, you indicate that you have read this document and you agree with the terms stated below.

It is the responsibility of the purchaser to follow all installation instruction guidelines and safety procedures supplied with your Borla Performance Exhaust System

Borla Performance Industries assumes no responsibility for damages occurring from misuse, abuse, improper installation, improper operation, lack of responsible care, or all previously stated reasons resulting from incompatibility with other manufacturer's products and/or systems.

Included with your Borla Performance Exhaust System is a warranty card. Please read it carefully before you begin any work on your vehicle. If you should have any questions regarding our warranty policy, installation, or any other matter pertaining to your new Borla Performance Exhaust System, please give us a call at the number provided on the warranty card.

Minimum Required Tool List:**TOOLS:**

- 1 3/8" Drive Ratchet
- 2 3/8" Drive Extension 3"
- 3 8mm Socket
- 4 10mm Socket
- 5 15mm Socket
- 6 T25 Torx bit
- 7 Flat head screwdriver
- 8 Phillips head screwdriver
- 9 15mm combination wrench

SHOP SUPPLIES:

- 1 Spray Lubricant

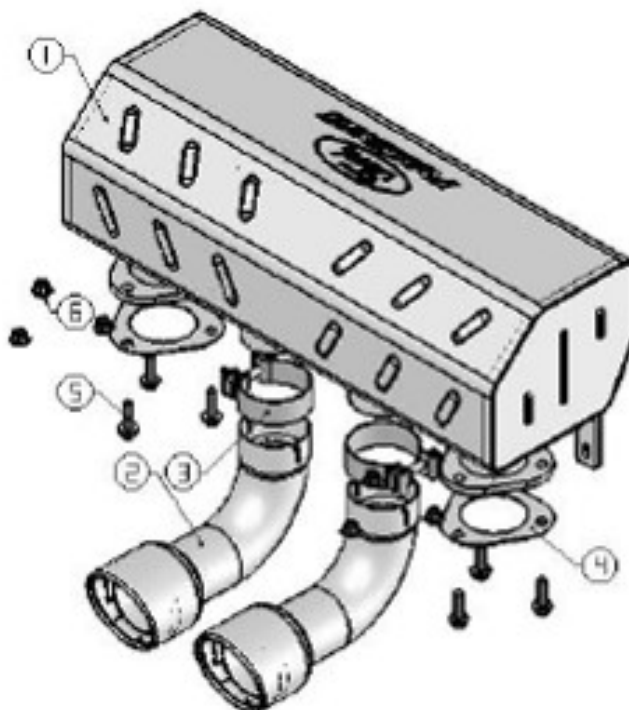
Ford Racing Performance Parts Exhaust Kit Bill of Materials

- 1. Muffler assembly
- 2. Tail pipe assembly (qty 2)
- 3. 3.00" clamp (qty 2)
- 4. Collector gasket
- 5. Bolt (qty 6)
- 6. Lock nut (qty 6)

Caution!!! *Never work on a hot exhaust system. Serious injury in the form of burns can result* If the vehicle has been in use and the exhaust system is hot, allow vehicle to cool for at least 1 hour. Always wear eye protection when working under any vehicle.

Note: It is our recommendation that you use a hoist or hydraulic lift to facilitate the installation of your new Borla Performance Rear Section Exhaust System.

Taking all under car safety precautions, lift the vehicle using a hoist or hydraulic lift. Once this has been done, you may begin the removal of your old exhaust system from your vehicle.

Note: Before removing the original exhaust system from your vehicle, please compare the parts you have received with the bill of materials provided on the previous page to assure that you have all the parts necessary for the installation of your new Borla Performance Rear Section Exhaust System.

Note: With a used vehicle, we suggest a penetrating spray lubricant to be applied liberally to all exhaust fasteners and allowing a significant period of time for the chemical to lubricate the threads before attempting to disassemble.

Original Exhaust System Removal

1. Using a 10mm socket, unbolt and carefully remove the rear bumper. (See Fig. 1)
2. Using a flat head screwdriver, disconnect the electrical connector located on the driver rear of the vehicle under the engine cover. (See Fig.2)
3. Using a flat head screwdriver, remove the retaining clips from each engine cover support. (See Fig.3)
4. Using needle nose pliers or something similar, remove the retaining clips from each pin located on each engine cover hinge as shown. (See Fig. 4)
5. With a few additional people supporting the engine cover, remove the engine cover supports and the hinge pins.
6. Carefully remove the engine cover from the vehicle as shown in figure

Warning: Use extreme caution during installation. Torque all fasteners according to manufacturer's torque values and tightening sequence. DO NOT use air impact tools to tighten fasteners on Borla Performance Exhaust Systems. Use of such tools may result in bent flanges or gasket contact areas leading to exhaust leaks.



Figure 1



Figure 2



Figure 3

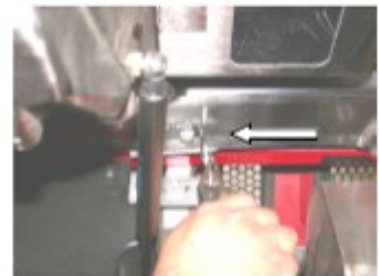

Figure 4



Figure 5

Caution!!! Never work on a hot exhaust system. Serious injury in the form of burns can result If the vehicle has been in use and the exhaust system is hot, allow vehicle to cool for at least 1 hour. Always wear eye protection when working under any vehicle.

Note: It is our recommendation that you use a hoist or hydraulic lift to facilitate the installation of your new Borla Performance Rear Section Exhaust System.

Taking all under car safety precautions, lift the vehicle using a hoist or hydraulic lift. Once this has been done, you may begin the removal of your old exhaust system from your vehicle.

Note: Before removing the original exhaust system from your vehicle, please compare the parts you have received with the bill of materials provided on the previous page to assure that you have all the parts necessary for the installation of your new Borla Performance Rear Section Exhaust System.

Original Exhaust System Removal (continued)

7. Using a T25 torx bit, unbolt and remove the air diffuser located at the bottom rear of the vehicle. (See Fig. 6)
8. Using an 8mm socket, unbolt and remove the rear lower grille assembly. (See Fig. 7)
9. Using an 8mm socket, unbolt the rear upper grille assembly from the frame of the vehicle.
10. Using a Phillips head screwdriver, unscrew and remove each upper fender well. (See Fig. 8)
11. Without removing the rear tires, using a miniature Phillips +head screwdriver, unscrew each inner fender well from the rear body of the vehicle. (See Fig. 9)
12. Disconnect the tail lights, side marker lights and license plate lights.
13. Unbolt and remove the license plate frame and license plate from the vehicle.
14. Using a T25 torx bit, 8mm socket and 10mm socket, unbolt and remove the rear body of the vehicle. (See Fig. 10)
15. Unbolt the muffler from the brackets located on each side at the front of the muffler as shown. Place the hardware aside for use during the installation of your new exhaust system. (See Fig. 11)
16. Using a 14mm socket and combination wrench, unbolt the collector flanges. (See Fig. 12)
17. Carefully remove the muffler from the vehicle. (See Fig. 13)



Figure 6



Figure 7



Figure 8



Figure 9



Figure 10

Caution!!! *Never work on a hot exhaust system. Serious injury in the form of burns can result* If the vehicle has been in use and the exhaust system is hot, allow vehicle to cool for at least 1 hour. Always wear eye protection when working under any vehicle.

Note: It is our recommendation that you use a hoist or hydraulic lift to facilitate the installation of your new Borla Performance Rear Section Exhaust System.

Taking all under car safety precautions, lift the vehicle using a hoist or hydraulic lift. Once this has been done, you may begin the removal of your old exhaust system from your vehicle.

Note: Before removing the original exhaust system from your vehicle, please compare the parts you have received with the bill of materials provided on the previous page to assure that you have all the parts necessary for the installation of your new Borla Performance Rear Section Exhaust System.

Borla Performance Exhaust Cat-Back Installation

1. Place your new muffler assembly into position as shown. (See Fig. 14)
2. Using the original hardware, secure the muffler to the factory brackets. Hand tighten the hardware for now.
3. Install the gaskets and hardware supplied for each flange and hand tighten the hardware for now.

Note: When you first start your vehicle after the installation of your new Borla Performance Exhaust System, there may be some smoke and fumes coming from the system. This is a protective oil based coating used in the manufacturing of mandrel bent performance exhaust tubing. This is not a problem and will disappear within a very short period of time after the exhaust has reached normal operating temperatures.



Figure 11

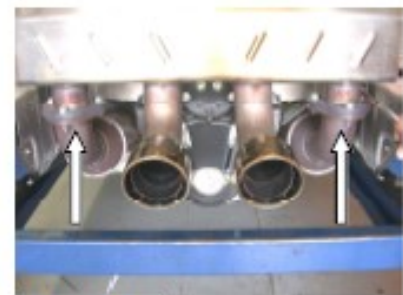

Figure 12



Figure 13



Figure 14

Caution!!! *Never work on a hot exhaust system. Serious injury in the form of burns can result* If the vehicle has been in use and the exhaust system is hot, allow vehicle to cool for at least 1 hour. Always wear eye protection when working under any vehicle.

Note: It is our recommendation that you use a hoist or hydraulic lift to facilitate the installation of your new Borla Performance Rear Section Exhaust System.

Taking all under car safety precautions, lift the vehicle using a hoist or hydraulic lift. Once this has been done, you may begin the removal of your old exhaust system from your vehicle.

Note: Before removing the original exhaust system from your vehicle, please compare the parts you have received with the bill of materials provided on the previous page to assure that you have all the parts necessary for the installation of your new Borla Performance Rear Section Exhaust System.

Borla Performance Exhaust Cat-Back Installation

12. Place a clamp over the expanded end of each tail pipe assembly and slide them onto the muffler outlets. (See Fig. 15)
13. Temporarily install the rear bumper and align the tips. (See Fig. 16)
14. Check your exhaust system for proper clearance under the vehicle and also for tip alignment.
15. Once position has been determined to be correct, tighten the clamps to 32-35 ft. lbs.
16. Tighten the collector flanges and the muffler brackets to 18-22 ft. lbs.
17. Before starting your vehicle, make sure to check all wires, hoses, brake lines, body parts and tires for safe clearance from the exhaust system.
18. Start vehicle and check for any leaks. If any leaks are found, determine cause (such as loose or incorrectly positioned clamp) and repair as necessary.
19. Install all body pieces, license plate, license plate frame, bumper and wiring opposite of removal.

Note: When you first start your vehicle after the installation of your new Borla Performance Exhaust System, there may be some smoke and fumes coming from the system. This is a protective oil based coating used in the manufacturing of mandrel bent performance exhaust tubing. This is not a problem and will disappear within a very short period of time after the exhaust has reached normal operating temperatures.



Figure 15



Figure 16