

Installation Guide for Ford F-150 Tremor 3.5L

PNs 60731, 60732



******* Please compare the parts in the box with the bill of materials provided *****
to assure that you have all the parts necessary for this installation.**

These instructions have been written to help you with the installation of your Borla Performance exhaust system. Please read this document completely before beginning the installation of your system.

To ensure this part number fits your specific model year, please visit our website for the latest model year listings at www.BORLA.com

Thank you for purchasing a Borla Performance exhaust system.

Borla Performance Mid Section Exhaust System PNs 60731 and 60732 are designed for the Ford F-150 Tremor equipped with a 3.5L V6 twin turbo-charged engine and 4WD automatic transmission.

Borla Performance Industries recommends that an exhaust shop or professional after market parts installer, who has all the necessary equipment, tools and experienced personnel needed for proper installation, should perform the installation of this system. However, if you decide to perform the installation, we recommend someone should help you. Ensure the installer uses all under car safety precautions including eye protection.

Please take time to read and understand the following...

By installing your Borla Performance exhaust system, you indicate that you have read this document and you agree with the terms stated below.

It is the responsibility of the purchaser to follow all installation instruction guidelines and safety procedures supplied with your Borla Performance exhaust system.

Borla Performance Industries assumes no responsibility for damages occurring from misuse, abuse, improper installation, improper operation, lack of responsible care, or all previously stated reasons resulting from incompatibility with other manufacturer's products and/or systems.

Included with your Borla Performance exhaust system is a warranty card. Please read it carefully before you begin any work on your vehicle. If you should have any questions regarding our warranty policy, installation, or any other matter pertaining to your new Borla Performance exhaust system, please give us a call at the number provided on the warranty card.

Minimum Required Tool List:

TOOLS:

1. 3/8" drive ratchet
2. 3/8" drive extension 6"
3. 10mm socket
4. 13mm socket
5. 15mm deep well socket
6. Pry bar

SHOP SUPPLIES:

1. Spray lubricant

Borla Performance - Bill of Materials

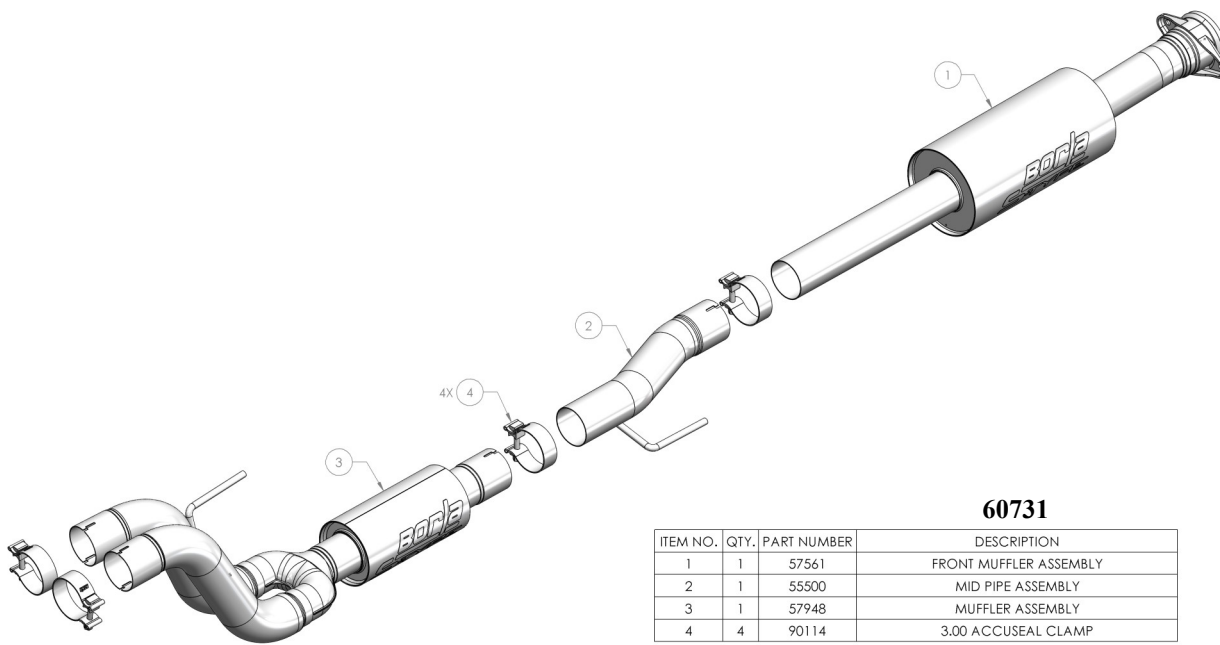

60731

ITEM NO.	QTY.	PART NUMBER	DESCRIPTION
1	1	57561	FRONT MUFFLER ASSEMBLY
2	1	55500	MID PIPE ASSEMBLY
3	1	57948	MUFFLER ASSEMBLY
4	4	90114	3.00 ACCUSEAL CLAMP

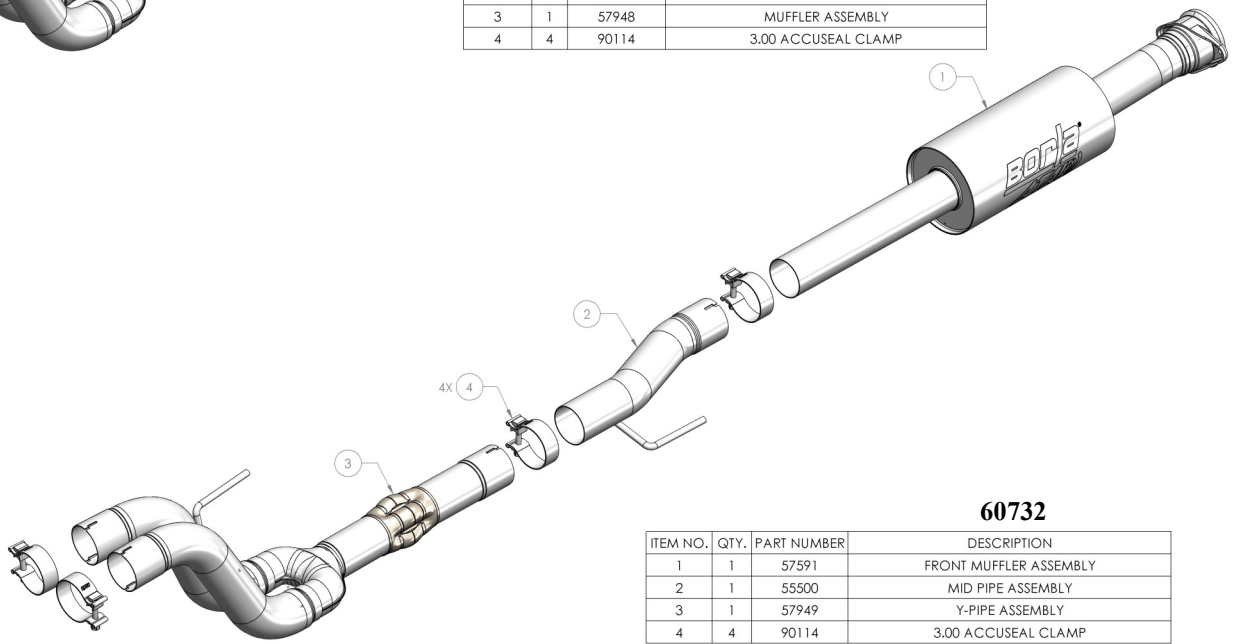

60732

ITEM NO.	QTY.	PART NUMBER	DESCRIPTION
1	1	57591	FRONT MUFFLER ASSEMBLY
2	1	55500	MID PIPE ASSEMBLY
3	1	57949	Y-PIPE ASSEMBLY
4	4	90114	3.00 ACCUSEAL CLAMP

Caution!!! *Never work on a hot exhaust system. Serious injury in the form of burns can result. If the vehicle has been in use and the exhaust system is hot, allow vehicle to cool for at least 1 hour. Always wear eye protection when working under any vehicle.*

Note: *It is our recommendation that you use a hoist or hydraulic lift to facilitate the installation of your new Borla Performance Exhaust System.*

Taking all under car safety precautions, lift the vehicle using a hoist or hydraulic lift. Once this has been done, you may begin the removal of your old exhaust system from your vehicle.

Note: *Before removing the original exhaust system from your vehicle, please compare the parts you have received with the bill of materials provided on the previous page to assure that you have all the parts necessary for the installation of your new Borla Performance Exhaust System.*

Note: *With a used vehicle, we suggest a penetrating spray lubricant to be applied liberally to all exhaust fasteners and allowing a significant period of time for the chemical to lubricate the threads before attempting to disassemble.*

Original Exhaust System Removal

1. Lubricate all hangers, rubber isolators, bolts and nuts.
2. Remove the hardware attaching the passenger rear tailpipe isolator assembly to the vehicle (Fig. 1). Save hardware and isolator assembly for tailpipe installation.
3. Remove the hardware attaching the passenger middle tailpipe isolator assembly to the vehicle (Fig. 2). Save hardware and isolator assembly for tailpipe installation.
4. Loosen clamp at the over axle pipe and passenger tailpipe connection. Using a flathead screwdriver or a prybar, lift the locking tab at the passenger tailpipe inlet (Figs. 3-4).
5. Remove the passenger tailpipe assembly by angling the assembly down toward the rear of the vehicle (Fig. 5).

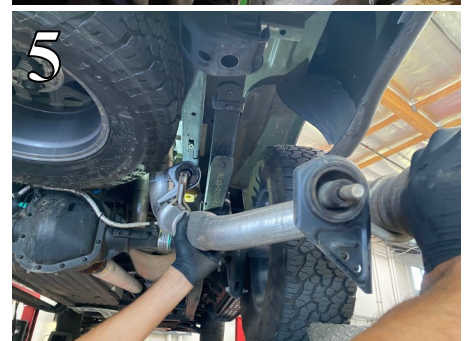
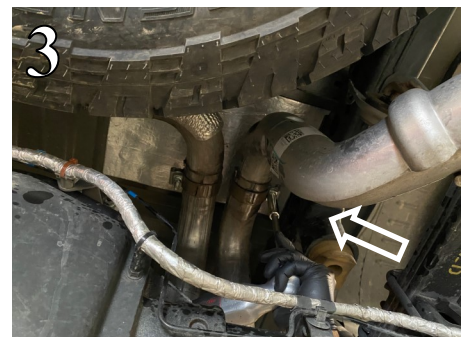
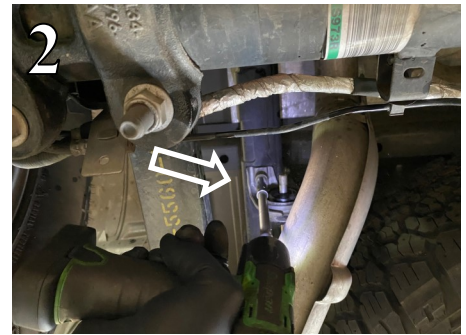
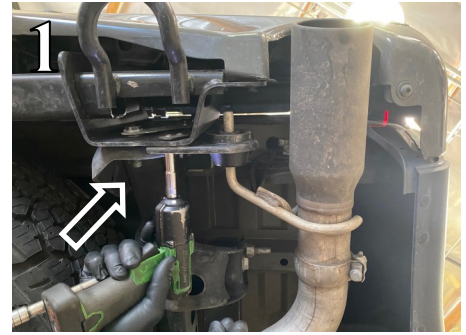

Original Exhaust System Removal Cont'd

6. Repeat steps 2-5 for removal of driver's side tailpipe assembly (Figs. 6-8).
7. Remove the two bolts attaching the flange of the muffler assembly to the vehicle (Fig. 9). Save stock hardware for installation.
8. Using a flathead screwdriver or a prybar, remove the rubber isolator from the hanger on the muffler assembly and remove the muffler assembly from the vehicle (Fig. 10).
9. Original exhaust system removed.

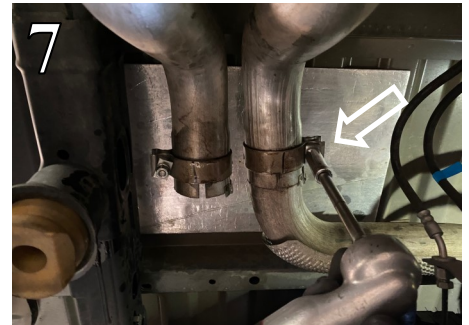

Borla Performance Mid Section Exhaust System Installation

1. Orient components on shop floor according to Borla bill of materials drawing on page 2.
2. Install **Front Muffler Assembly** by mating the flange to the vehicle. (Figs. 11-12). Lightly tighten the original hardware.
3. Place a clamp over the expanded end of the **Mid Pipe Assembly** and insert the inlet to the **Front Muffler Assembly**. Insert the hanger into the original rubber isolator (Fig. 13). Do not tighten the clamp.
4. Slide the outlet side of the **Muffler Assembly** or **Y-Pipe Assembly** over the top of the axle. Place a clamp over the expanded end of the **Muffler Assembly** or **Y-Pipe Assembly** and insert the inlet to the **Mid Pipe Assembly**. Insert the hanger into the original rubber isolator (Figs. 14-15). Do not tighten the clamp.

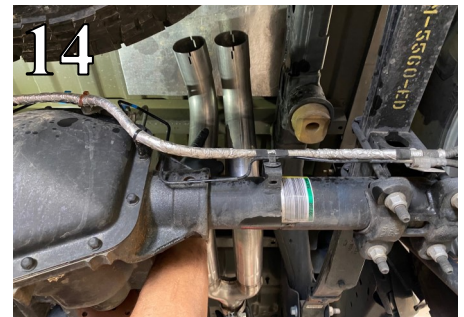

Borla Performance Mid Section Exhaust System Installation Cont'd

Optional Tailpipes PN 60640BC are shown in this installation. You can reinstall original tailpipes by following this guide.

5. Place the original rubber isolator assemblies onto their corresponding hangers on the **R/H Tail Pipe Assembly**. Place a clamp over the expanded end of the **R/H Tail Pipe Assembly** and feed it up and over the axle and insert the inlet to the **Muffler Assembly** or **Y-Pipe Assembly**. Install the original hardware to the original rubber isolator assemblies and tighten them to the vehicle (Figs. 16-17). Do not tighten the clamp.
6. Place a clamp over the expanded end of the **L/H Cross-Over Pipe** and feed it up and over the axle and insert the inlet to the **Muffler Assembly** or **Y-Pipe Assembly** (Fig. 18). Do not tighten the clamp.
7. Place the original rubber isolator assemblies onto their corresponding hangers on the **L/H Tail Pipe Assembly**. Place a clamp over the expanded end of the **L/H Tail Pipe Assembly** and insert the inlet to the **L/H Cross-Over Pipe**. Install the original hardware to the original rubber isolator assemblies and tighten them to the vehicle (Figs. 19-20). Do not tighten the clamp.
8. Once position has been determined to be correct, tighten the Accuseal clamps to 32-35 ft. lbs. and tighten the original hardware (Figs. 21-22).
9. Before starting your vehicle, make sure to check all wires, hoses, brake lines, body parts and tires for safe clearance from the exhaust system.
10. Start the vehicle and check for any leaks. If any leaks are found, determine cause (such as loose fitting on the flange) and repair as necessary.

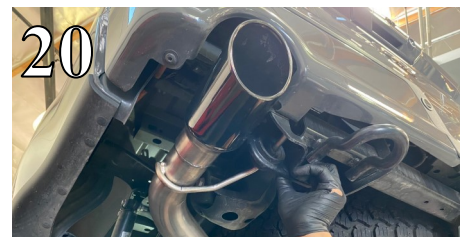
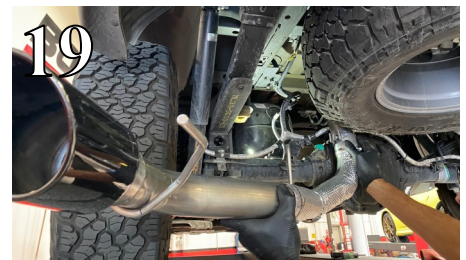
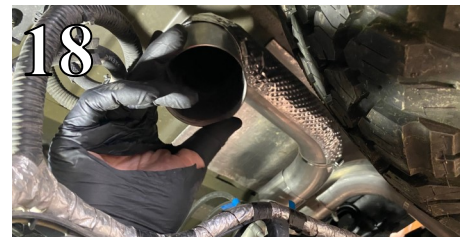

WARNING: Use extreme caution during installation. Torque all fasteners according to manufacturer's torque values and tightening sequence. **DO NOT** use air impact tools to tighten fasteners on Borla Performance Exhaust Systems. Use of such tools may result in bent flanges or gasket contact areas leading to exhaust leaks.

NOTE: When you first start your vehicle after the installation of your new Borla Performance Exhaust System, there may be some smoke and fumes coming from the system. This is a protective oil based coating used in the manufacturing of mandrel bent performance exhaust tubing. This is not a problem and will disappear within a very short period of time after the exhaust has reached normal operating temperatures.