

## Installation Guide for Ford F-250 / F-350 Super Duty

PNs: 141016, 141016BC, & 141016BRCB



**\*\*\*\*\* Please compare the parts in the box with the bill of materials provided \*\*\*\*\*  
to assure that you have all the parts necessary for this installation.**

These instructions have been written to help you with the installation of your Borla Performance exhaust system. Please read this document completely before beginning the installation of your system.

To ensure this part number fits your specific model year, please visit our website for the latest model year listings at [www.BORLA.com](http://www.BORLA.com)

Thank you for purchasing a Borla Performance Cat-Back™ exhaust system.

Borla Performance Cat-Back™ exhaust systems PN 141016, 141016BC, and 141016BRCB are designed for the Ford F-250 & F-350 Super Duty, equipped with a 6.2L, 6.8L or 7.3L V8 engine and automatic 2WD or 4WD transmission (Crew Cab Short Bed; 159.7" wheelbase).

Borla Performance Industries recommends that an exhaust shop or professional after market parts installer, who has all the necessary equipment, tools and experienced personnel needed for proper installation, should perform the installation of this system. However, if you decide to perform the installation, we recommend someone should help you. Ensure the installer uses all under car safety precautions including eye protection.

*Please take time to read and understand the following...*

By installing your Borla Performance exhaust system, you indicate that you have read this document and you agree with the terms stated below.

It is the responsibility of the purchaser to follow all installation instruction guidelines and safety procedures supplied with your Borla Performance Exhaust System.

Borla Performance Industries assumes no responsibility for damages occurring from misuse, abuse, improper installation, improper operation, lack of responsible care, or all previously stated reasons resulting from incompatibility with other manufacturer's products and/or systems.

Included with your Borla Performance exhaust system is a warranty card. Please read it carefully before you begin any work on your vehicle. If you should have any questions regarding our warranty policy, installation, or any other matter pertaining to your new Borla Performance exhaust system, please give us a call at the number provided on the warranty card.

**Minimum Required Tool List:**

**TOOLS:**

1. 3/8" drive ratchet
2. 3/8" drive extension 6"
3. 15mm deep well socket
4. 13mm socket

5. Pry bar

**SHOP SUPPLIES:**

1. Spray lubricant

**Borla Performance - Bill of Materials**

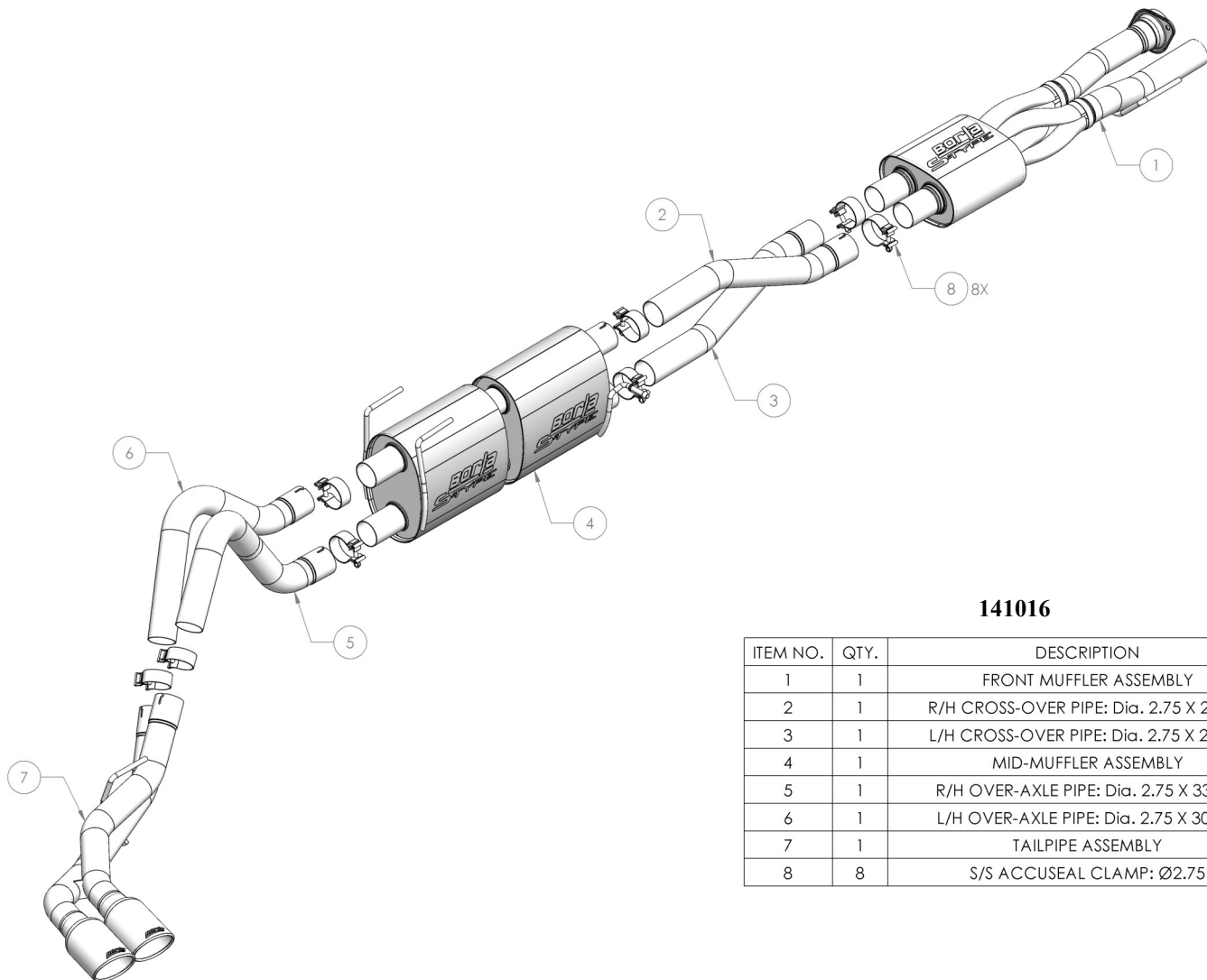

**141016**

ITEM NO.	QTY.	DESCRIPTION
1	1	FRONT MUFFLER ASSEMBLY
2	1	R/H CROSS-OVER PIPE: Dia. 2.75 X 27.68"
3	1	L/H CROSS-OVER PIPE: Dia. 2.75 X 27.00"
4	1	MID-MUFFLER ASSEMBLY
5	1	R/H OVER-AXLE PIPE: Dia. 2.75 X 33.25"
6	1	L/H OVER-AXLE PIPE: Dia. 2.75 X 30.75"
7	1	TAILPIPE ASSEMBLY
8	8	S/S ACCUSEAL CLAMP: Ø2.75

**Caution!!!** *Never work on a hot exhaust system. Serious injury in the form of burns can result if the vehicle has been in use and the exhaust system is hot, allow vehicle to cool for at least 1 hour. Always wear eye protection when working under any vehicle.*

**Note:** *It is our recommendation that you use a hoist or hydraulic lift to facilitate the installation of your new Borla Performance exhaust system.*

**Taking all under car safety precautions, lift the vehicle using a hoist or hydraulic lift. Once this has been done, you may begin the removal of your old exhaust system from your vehicle.**

**Note:** *Before removing the original exhaust system from your vehicle, please compare the parts you have received with the bill of materials provided on the previous page to assure that you have all the parts necessary for the installation of your new Borla Performance exhaust system.*

**Note:** *With a used vehicle, we suggest a penetrating spray lubricant to be applied liberally to all exhaust fasteners and allowing a significant period of time for the chemical to lubricate the threads before attempting to disassemble.*

## Original Exhaust System Removal

1. Lubricate all hangers, rubber isolators, bolts and nuts.
2. Remove the rear muffler assembly hangers from their rubber isolators (Figs. 1-2).
3. Loosen the clamp connecting the rear muffler assembly to the mid muffler assembly (Fig. 2).
4. With the rear muffler assembly and tailpipe assembly as one piece, slide the tailpipe assembly's hanger rearward out of its rubber isolator using a muffler stand or an additional person (Fig. 3).
5. Loosen the clamp connecting the mid muffler assembly to the front muffler assembly and remove it (Fig. 4).
6. Loosen and remove the hardware and clamp securing the front muffler assembly flange to the vehicle (Fig. 5). Save hardware and clamp for installation of your Borla system.
7. Loosen and remove the hardware securing the front muffler assembly rubber isolator bracket to the vehicle and remove the rubber isolator bracket from the vehicle (Fig. 6). Save hardware and rubber isolator assembly for re-installation.
8. Remove the front muffler assembly from the vehicle (Fig. 7).
9. Original exhaust system removed.

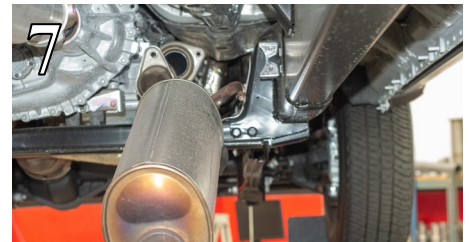
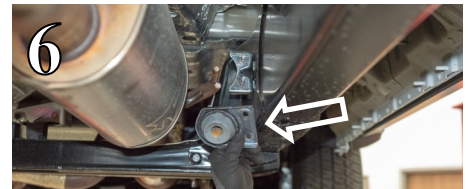
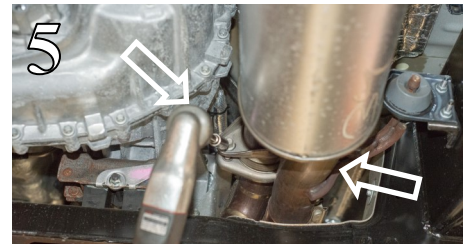
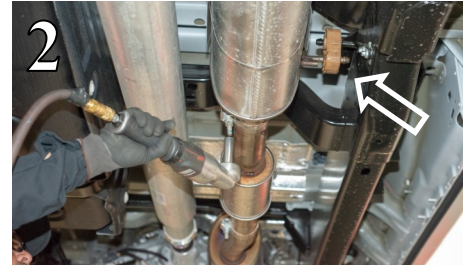

## Borla Performance Cat-Back™ Exhaust System Installation

1. Orient components on shop floor according to Borla bill of materials drawing on page 2.
2. Reinstall the original rubber isolator bracket onto the vehicle using the original hardware (Fig. 8).
3. Install **Front Muffler Assembly** by first sliding the inlet into the clamp and then mating the flange to the vehicle. Loosely tighten the original hardware on the flange (Figs. 8-9). Do not tighten the clamp.
4. Place a clamp over the expanded end of the **R/H Cross-Over Pipe** and insert the inlet to the **Front Muffler Assembly** (Fig. 10). Do not tighten the clamp.
5. Repeat Step 4 for installation of the **L/H Cross-Over Pipe**.
6. Place a clamp over the each of the expanded ends of the **Mid-Muffler Assembly** and insert each of the inlets to their corresponding **Cross-Over Pipe**. Insert the hangers into their original rubber isolators (Fig. 11). Do not tighten the clamps.
7. Place a clamp over the expanded end of the **L/H Over-Axle Pipe** and insert the inlet to corresponding outlet of the **Mid-Muffler Assembly** (Fig. 12). Do not tighten the clamp.
8. Repeat Step 7 for installation of the **R/H Over-Axle Pipe**.
9. Place a clamp over each of the expanded ends of the **Tailpipe Assembly** and insert each of the inlets to their corresponding **Over-Axle Pipe**. Insert the hanger into the original rubber isolator (Fig. 13). Do not tighten the clamp.
10. Once position has been determined to be correct, tighten the hardware on the **Front Muffler Assembly** and then tighten the Accuseal clamps to 32-35 ft. lbs.
11. Before starting your vehicle, make sure to check all wires, hoses, brake lines, body parts and tires for safe clearance from the exhaust system.
12. Start the vehicle and check for any leaks. If any leaks are found, determine cause (such as loose or incorrectly positioned clamp) and repair as necessary.

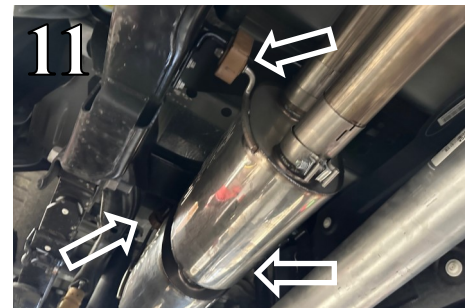

**WARNING:** Use extreme caution during installation. Torque all fasteners according to manufacturer's torque values and tightening sequence. **DO NOT** use air impact tools to tighten fasteners on Borla Performance exhaust systems. Use of such tools may result in bent flanges or gasket contact areas leading to exhaust leaks.

**NOTE:** When you first start your vehicle after the installation of your new Borla Performance exhaust system, there may be some smoke and fumes coming from the system. This is a protective oil based coating used in the manufacturing of mandrel bent performance exhaust tubing. This is not a problem and will disappear within a very short period of time after the exhaust has reached normal operating temperatures.